

# Buranda station accessibility upgrade

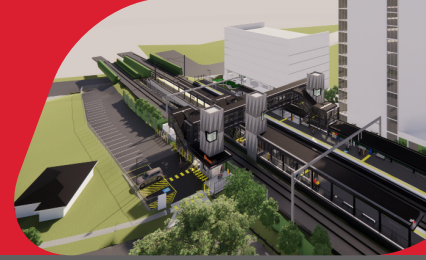

PROJECT UPDATE – MAY 2024

The Buranda station accessibility upgrade is part of the State Government's ongoing investment to upgrade stations to make them accessible for everyone.

## About the project

Buranda station is being upgraded to make it more accessible, and easier for customers and the community to travel on our network.

The new, modern station will help people in wheelchairs, parents with prams and those travelling with luggage or who are injured, use the station with ease.

## Project status

The following works have been carried out recently at Buranda station:

- commencement of construction of piling pads and piling works for new footbridge, lifts and retaining wall on platforms 1 and 2 (see images)
- completion of overhead line infrastructure works.

## Upcoming works

Customers and the local community can expect to see the following activity in the coming weeks:

- completion of piling works for platform 2 retaining wall
- ongoing in-ground services works on the platforms
- ongoing construction of concrete substructure works for the new lifts, footbridge and shelters.

Works will generally take place between **6am and 6pm Monday to Saturday**, unless notified. Every effort will be made to carry out these works with respect for our neighbours and customers.

## Upcoming night and weekend works

From **7pm until 4am the next day on Wednesday 29 May** precast platform copes will be delivered to site.

Around the clock works will take place during planned track closures on the Cleveland line on the following weekends in June:

- Saturday 1 and Sunday 2 June
- Saturday 15 and Sunday 16 June
- Saturday 29 and Sunday 30 June
- Saturday 6 and Sunday 7 July.

Works will include:

- installation of precast platform copes
- installation of platform 1 precast lift shaft and carpark precast column for bridge
- ongoing civil works on platforms.



## Contact us

- Phone: [1800 722 203](tel:1800722203) (free call)
- Email: [stationsupgrade@qr.com.au](mailto:stationsupgrade@qr.com.au)
- Website: [queenslandrail.com.au](http://queenslandrail.com.au)